

3-2 WIPER REPLACEMENT

1 Turn on the SUB POWER SW while pressing the [CLEANING] key to enter the maintenance mode.

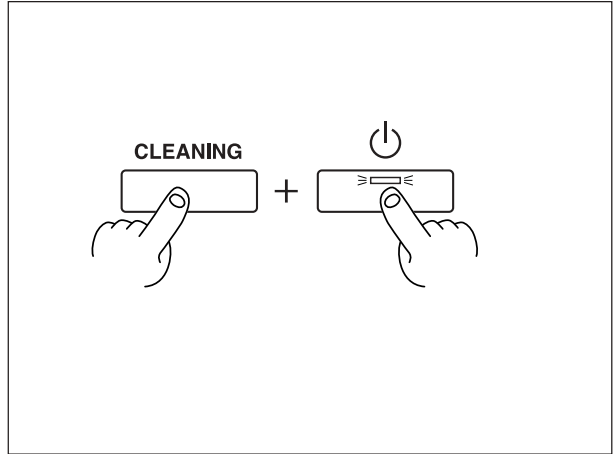

3

2 Select [WIPER REPLACE] and press the [ENTER] key. The head moves to the left side.

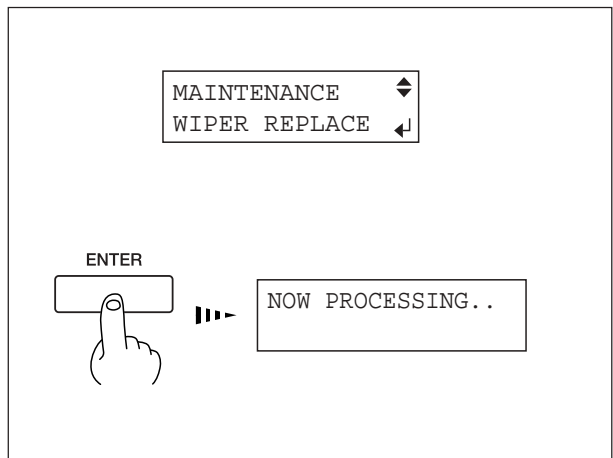

3 Make sure the screen shown in the figure is displayed. Then, remove the I/S COVER.

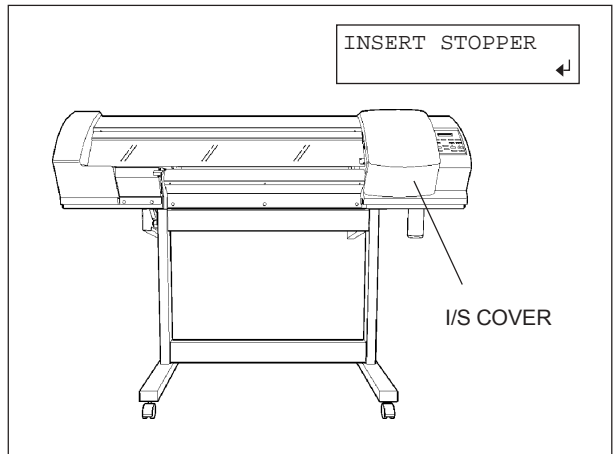

4 Attach the Cleaning Stick at the location as shown in the figure.

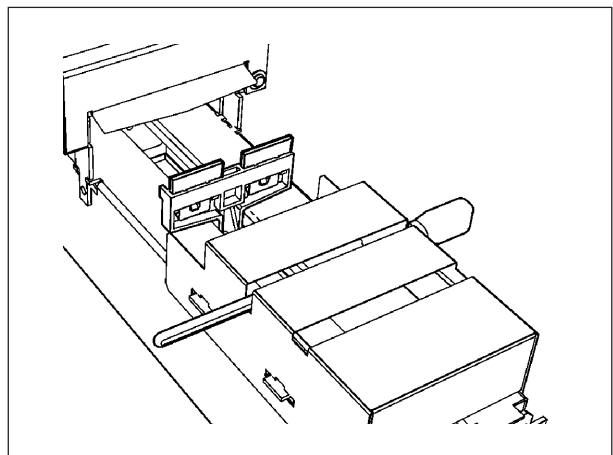

- 5 Using the tweezers, grasp the bottom portion of the wiper and take it off the hook.

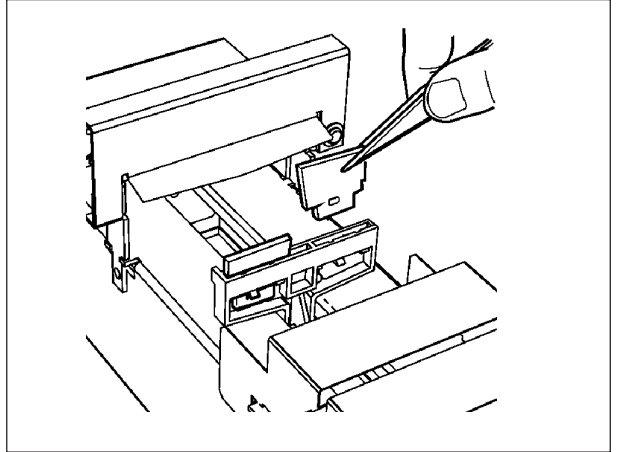

3

- 6 Use the tweezers to press the area shown in the figure and engage the WIPER on the hook.

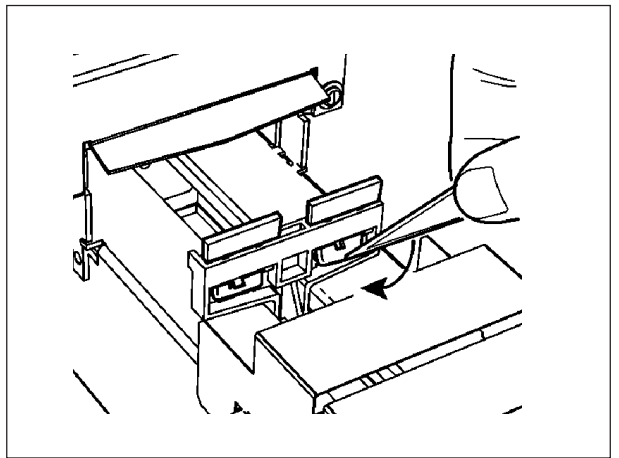

- 7 Remove the Cleaning Stick and fix the I/S Cover. Then, press the ENTER key.

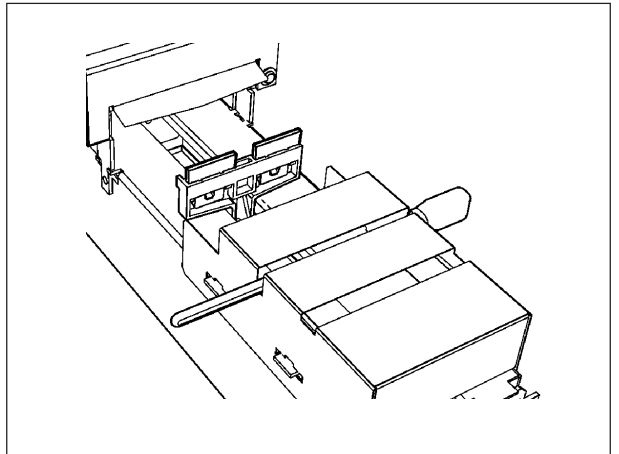

- 8 Head Cleaning starts automatically. After cleaning has finished, the Sub Power will be turned off automatically.

