

3-2 WIPER REPLACEMENT

1 Turn on the SUB POWER SW while pressing the [CLEANING] key to enter the maintenance mode.

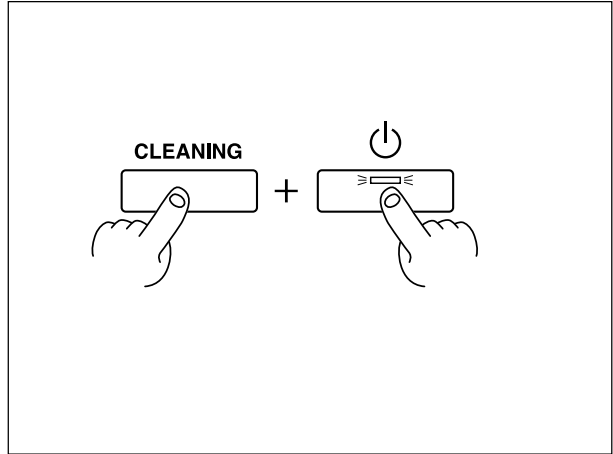

3

2 Select [WIPER REPLACE] and press the [ENTER] key. The head moves to the left side.

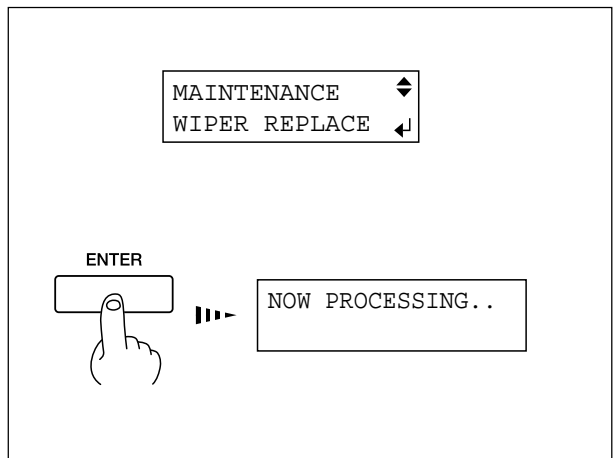

3 Make sure the screen shown in the figure is displayed. Then, remove the RIGHT I/S COVERS.

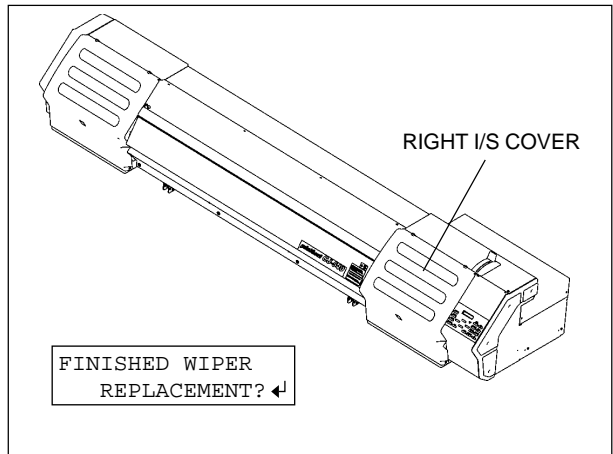

4 Using tweezers, grasp the bottom portion of the wiper and take it off the hook.

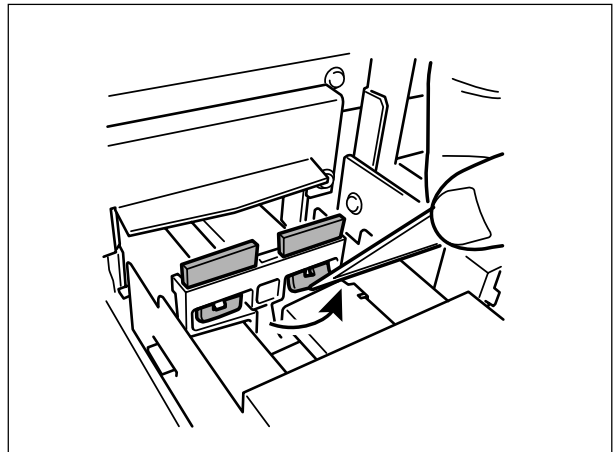

- 5** Remove the WIPER and install the new one.



Make sure to fix the wiper so that the rubber side faces the front.

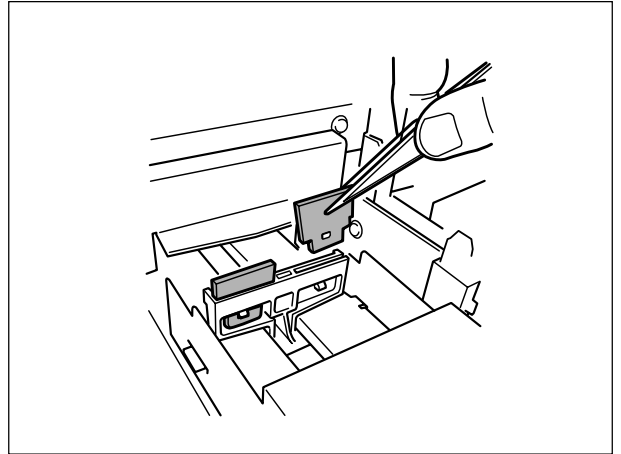

3

- 6** Use the tweezers to press the area shown in the figure and engage the WIPER on the hook.



Make sure to engage it on the hook. If the WIPER is not hooked, it may fall off during use.

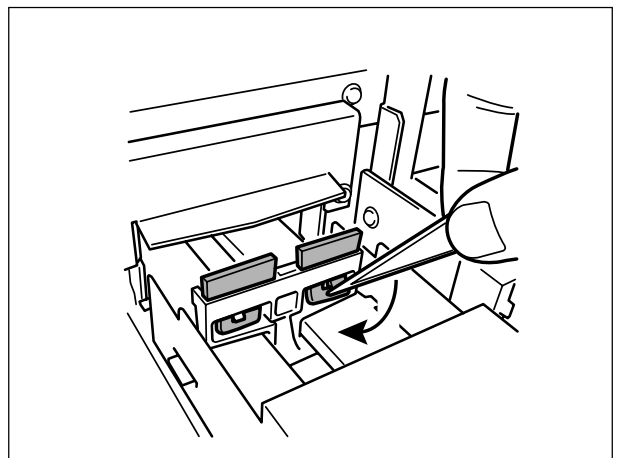

- 7** Fix the RIGHT I/S COVER and press the [ENTER] key. The head carriage moves back to the standby position and the head cleaning starts automatically. When the head cleaning finishes, the sub power will be turned off.

